

 Poster frame in wooden finish - corners cut in mitred. Supplied complete with white PS backplate and anti-reflex APET front panel, screws and plugs. Packed with 5 pcs.

 Klapp-Rahmen in Holzlook - Ecken auf Gehrung mit PS Rückwand in weiss sowie entspiegelter APET Frontscheibe. Komplett mit Schrauben und Dübeln geliefert. 5 Stück pro Karton.

 Klappramme i trælook med hjørner i gering. Hvid 1,5 mm PS bagplade samt APET antirefleks frontplade. Inklusiv skruer og plugs til montering. Pakket med 5 stk. pr. karton.



OPTIONAL HANGER  
ART. 3988

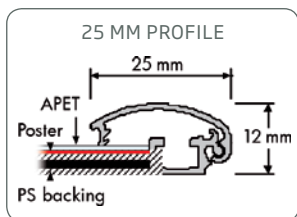
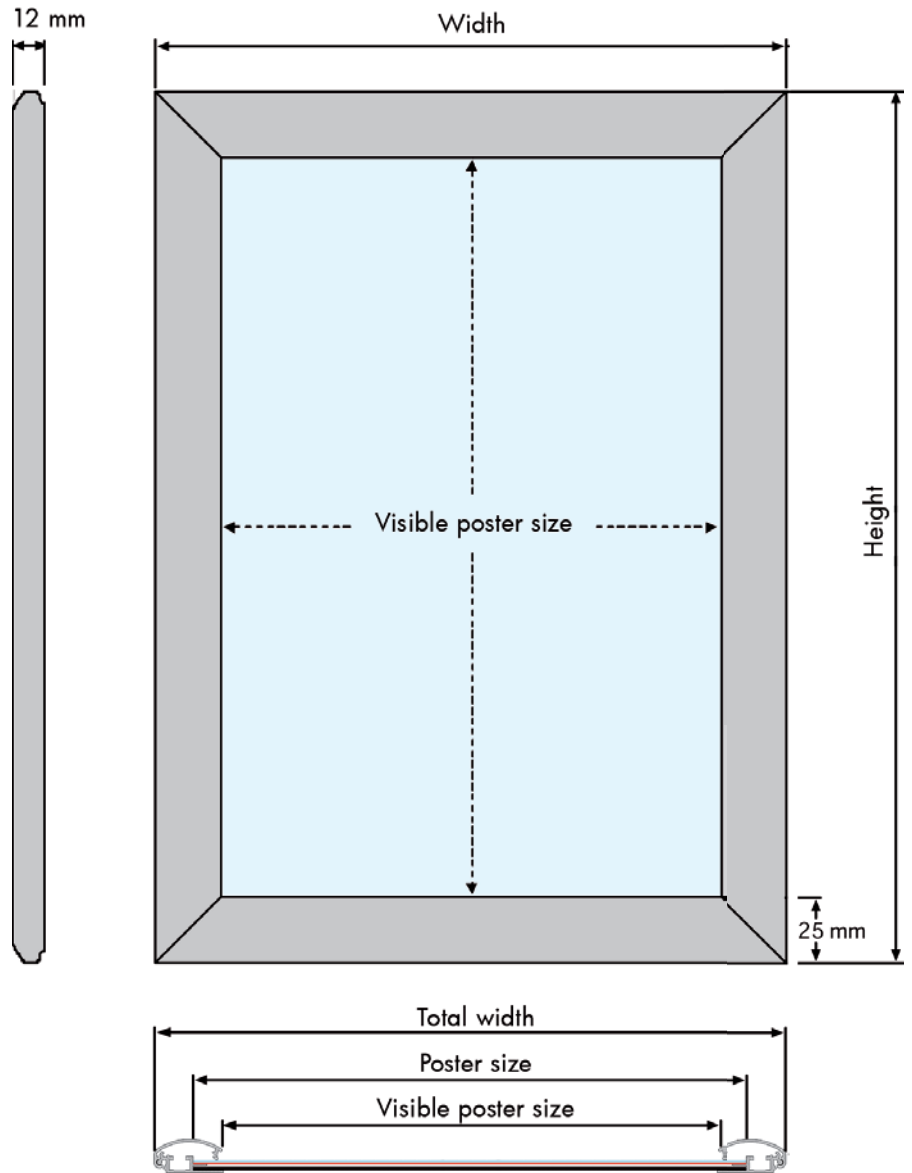
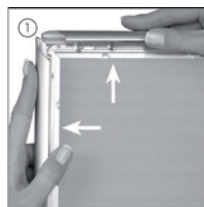

**GB** Open all profiles.  
**DE** Alle Profile öffnen.  
**DK** Åben alle profilerne.



**GB** Take-off the front panel.  
**DE** Frontscheibe abheben.  
**DK** Løft frontpladen op.

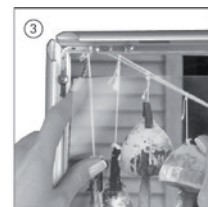

**GB** Place the poster in.  
**DE** Poster einlegen.  
**DK** Læg plakaten i.



**GB** Place the front panel and close the profiles.  
**DE** Frontscheibe einlegen und die Seitenprofile zuklappen.  
**DK** Læg frontpladen øverst og luk profilerne.

Model	Art.no.	Poster size	Visible size	Colour	Total W x H x D	Package size and weight	Pallet size and quantity
216	5750	21 x 29,7 cm A4	19,2 x 27,9 cm	Brown	23,9 x 32,6 cm	26 x 35 x 2,1 cm 0,6 kg	80 x 120 x 220 cm 750 pcs.
-	5751	29,7 x 42 cm A3	27,9 x 40,2 cm	-	32,6 x 44,9 cm	35 x 46 x 2,1 cm 0,8 kg	80 x 120 x 220 cm 350 pcs.
-	5752	42 x 59,4 cm A2	40,2 x 57,6 cm	-	44,9 x 62,3 cm	46 x 66 x 2,1 cm 1,0 kg	80 x 120 x 220 cm 330 pcs.
-	5753	50 x 70 cm	48,2 x 68,2 cm	-	52,9 x 72,9 cm	55 x 75 x 2,1 cm 1,3 kg	80 x 120 x 220 cm 320 pcs.
-	5754	59,4 x 84,1 cm A1	57,6 x 82,3 cm	-	62,3 x 87,0 cm	65 x 90 x 2,1 cm 1,7 kg	80 x 120 x 220 cm 205 pcs.
-	5755	70 x 100 cm	68,2 x 98,2 cm	-	72,9 x 102,9 cm	75 x 105 x 2,1 cm 2,3 kg	80 x 120 x 220 cm 165 pcs.